



Center for Public Safety Leadership



JAYHAWK HOSPITALITY



SRLEE 2025

University of Kansas, Lawrence
July 27-29, 2025



Exhibitor Prospectus



www.smallrural.org

Dear Valued Partner,

I invite you to join us at the 2025 Small and Rural Law Enforcement Executives Association (SRLEEA) Conference, where your business can make a direct impact on the agencies that form the backbone of law enforcement across the nation.

Small, rural, and tribal law enforcement agencies make up over 90% of all law enforcement departments in the U.S. We are the ones patrolling vast areas with limited personnel, keeping our communities safe despite resource constraints. Unlike larger agencies with bureaucratic purchasing processes, we, as executives, have the direct authority to make purchasing decisions. That means when you exhibit at SRLEEA, you're not just meeting potential buyers—you're meeting the decision-makers who can act.

A Personal and Engaged Environment – Unlike massive expos where vendors get lost in the crowd, our conference offers real face time with agency leaders looking for trusted vendors and long-term partnerships.

As the only national association solely focused on small, rural, and tribal law enforcement agencies, SRLEEA is uniquely positioned to connect you with the agencies that need your products and services the most.

I personally encourage you to secure your exhibitor space today and be part of the solutions that will shape the future of law enforcement in America's small and rural communities. We look forward to seeing you at the 2025 SRLEEA Conference!

Sincerely,

Sheriff Eli Rivera, President, Small and Rural Law Enforcement Executives Association (SRLEEA)



Why Exhibit at the 2025 SRLEEA Conference?

The Small and Rural Law Enforcement Executives Association (SRLEEA) Conference is the premier gathering of law enforcement leaders from small, rural, and tribal agencies across the nation. These agencies represent over 90% of law enforcement departments in the U.S. and face unique challenges in staffing, training, equipment, and technology—creating a prime opportunity for vendors to offer innovative solutions tailored to their needs.

By exhibiting at the SRLEEA Conference, your company will:

- ✔ Gain Direct Access to Decision-Makers – Meet and engage with police chiefs, sheriffs, and other executives who are actively seeking cost-effective, high-impact solutions for their agencies.
- ✔ Showcase Your Products & Services – Demonstrate how your technology, equipment, or services can enhance law enforcement operations in communities where resources are limited but the need for efficiency is critical.
- ✔ Expand Your Market Reach – Small and rural agencies may not have the purchasing power of major metropolitan departments, but collectively, they make up the largest segment of law enforcement in the U.S. Engaging with this market offers immense business potential.
- ✔ Network & Build Relationships – Strengthen your brand presence, form strategic partnerships, and develop long-term relationships with agencies looking for solutions tailored to their operational needs.
- ✔ Be Part of the Solution – Small, rural, and tribal agencies are often underserved when it comes to technology and resources. Your presence at SRLEEA demonstrates your commitment to public safety in all communities, not just large metropolitan areas.

With a rapidly growing membership base and an increasing demand for innovative law enforcement solutions, SRLEEA's annual conference is the ideal venue for showcasing your company to the agencies that need you the most. Don't miss this opportunity to position your brand at the forefront of law enforcement innovation.

Secure your exhibitor space today and connect with the leaders shaping the future of small, rural, and tribal law enforcement!



2025 SRLEEA Conference Schedule

Sunday, July 27, 2025

8:30 AM – 3:30 PM Registration Burge Forum Lobby

9:00 AM – 11:30 PM: SRLEEA Board Meeting (Burge Forum D)

9:00 PM – 4:00 PM: Vendor Setup (Burge Forum A, B & C)

9:00 AM – 4:00 PM: Sessions

DHS / FLETC Leadership Session and DHSLA Certification - Gray-Little Hall Auditorium, Room 1154

12:00 PM – 1:00 PM - Lunch on your own

1:00 AM – 4:00 PM: Sessions

DHS / FLETC Leadership Session and DHSLA Certification - Gray-Little Hall Auditorium, Room 1154

1:00 PM - 4:00 PM TBD Gray-Little 1146

1:00 PM – 1:50 PM- TBD - Burge Forum D

2:00 PM – 2:50 PM – Jewish Institute for the National Security of America (JINSA) first person insights into the devastating massacre in rural Israel. **(Law Enforcement Session Only)** Burge Forum D

3:00 PM -4:00 PM – Case Study, John Edward Robinson the Internet’s First Serial Killer “The Barrel Killer) **(Law Enforcement Session Only)** Burge Forum D

4:00 PM - 5:30 PM: Welcome Reception in Vendor Hall (Burge Forum A, B & C)



2025 SRLEEA Conference Schedule

Monday, July 28, 2025

8:00 AM – 3:30 PM Registration Burge Forum Lobby

7:30 AM – 9:00 AM: Breakfast in Vendor Hall (Burge Forum A, B & C)

Vendor Hall Open 8:00 – 5:00 PM

9:00 AM – 11:30 PM: Opening Session (Gray-Little Auditorium Room 1154 / Overflow in Gray-Little Classroom 1146)

- Posting of Colors (Need a Color Guard)
- Honor Fallen Law Enforcement Officers Video
- SRLEEA President Welcome
- Concerns of Police Survivors - Dianne Bernhard, Executive Director
- Welcome University of Kansas Leadership
- The Honorable Roger Marshall U.S. Senator
- The Honorable Gerald (Jerry) Moran U. S. Senator



Keynote Address:

- FBI Director / Deputy Director (Invited)
- Tony Schiena (confirmed)
- David Lau (confirmed)

11:30 AM – 1:00 PM: Lunch in Vendor Hall (Burge Forum A, B & C) (Box Lunches and Drinks)

1:00 PM – 5:00 PM: Concurrent Sessions

Gray-Little Hall Auditorium Room 1154 (90-minute sessions):

- 1:00 PM – 2:45 PM – TBD
- 3:00 PM – 4:45 PM- TBD

Gray-Little Hall Room 1146 (45-minute sessions):

- 1:00 PM – 1:45 PM - TBD
- 2:00 PM – 2:45 PM - TBD
- 3:00 PM – 3:45 PM - TBD
- 4:00 PM - 4:45 PM - TBD

Burge Forum D (45-minute sessions):

- 1:00 PM – 1:45 PM - TBD
- 2:00 PM – 2:45 PM - TBD
- 3:00 PM – 3:45 PM - TBD
- 4:00 PM – 4:45 PM - TBD



Tuesday, July 29, 2025

7:30AM – 9:00 AM Registration Burge Forum Lobby

7:30 AM – 8:30 AM: Breakfast in Vendor Hall (Burge Forum A, B C & D)

8:30 AM – 11:30 PM: Gray-Little Hall Auditorium Room 1154 (overflow in 1146) **Law Enforcement Only**
In-depth Study of the BTK Serial Killer case (Dennis Radar)

11:00 PM – 12:00 PM: Lunch & Visit with Vendors) (Burge Forum A, B, C & D) Prize Drawings

12:00 PM - Vendor Breakdown



SMALL & RURAL LAW ENFORCEMENT EXECUTIVES ASSOCIATION ANNUAL CONFERENCE

July 27 - 29, 2025, University of Kansas, Lawrence

EXHIBIT HALL/VENDOR SCHEDULE

Sunday July 27, 2025	Monday July 28, 2025	Tuesday July 29, 2025
-------------------------	-------------------------	--------------------------

Exhibitor Set Up
9 a.m. - 4 p.m.

Breakfast with Exhibitors
7:30 a.m. - 9:00 a.m.

Breakfast with Exhibitors
7:30 a.m. - 8:30 a.m.

4:00 p.m. to 6:00 p.m.
Evening Networking & Welcome Reception with Exhibitors

7:30 a.m. to 4:00 p.m.
Exhibit Hall Open
11:30 a.m. to 1:30 p.m.
Lunch with Exhibitors

7:30 a.m. to 12:30 p.m.
Exhibit Hall Open
11:30 a.m. to 12:30 p.m.
Lunch with Exhibitors & prize drawings

Free Time & Private Receptions

Free Time & Private Receptions

Vendor Breakdown
12:30 p.m. - 1:30 p.m.



<https://form.jotform.com/SRLEEA/2025exhibitor>

Email: conference@smallrural.org

Exhibit Space Rates:

- **Nonprofit Table:** \$950 (33 - 40)
- **10×10 standard booth:** \$2,500
- **10X10 booth with electric:** \$2,600 (as marked)
- **10X10 corner booth** - includes electric \$2,900 Booths (1, 8, 9, 16 17, 24, 25, & 32)
- **Super Booth / Private Room** with 2 entrances from the hall and 2 from the foyer. Also includes a table in the hall and or foyer along with signage in both places \$5,000 (Booth/Room 41)

Included in Booth Rental Package

- Booth space with back drape drape (not included in nonprofit tables)
- Booth Identification sign
- Three (3) complimentary exhibitor registrations per 10×10 booth.
- Listing on the conference website, www.smallrural.org.
- Listing in the online conference platform
- Online exhibit listing: Includes website links, PDFs, banner, company logo, & company description.
- Note: SRLEEA is providing in-person attendees access to our conference mobile app. The functionality of the mobile app Online Exhibit Listing differs from the full, interactive experience of Online Exhibit Listings viewed on our website website and Conference Platform.



To Reserve Your Space - <https://form.jotform.com/SRLEEA/2025exhibitor>



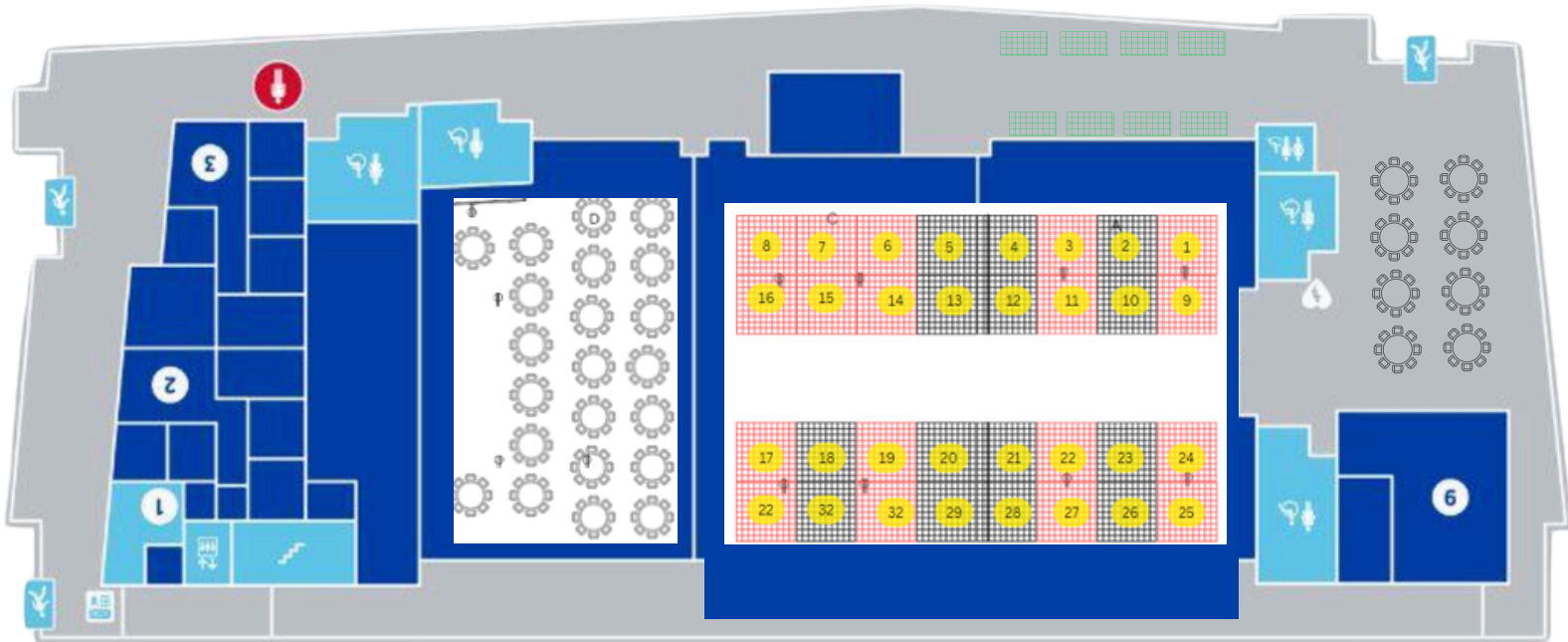

8 seat Rounds



Food Table



Non-Profit Table

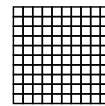

10x10 Vendor Booth & Table

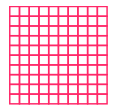

10x10 Vendor Booth & Table w/Electric

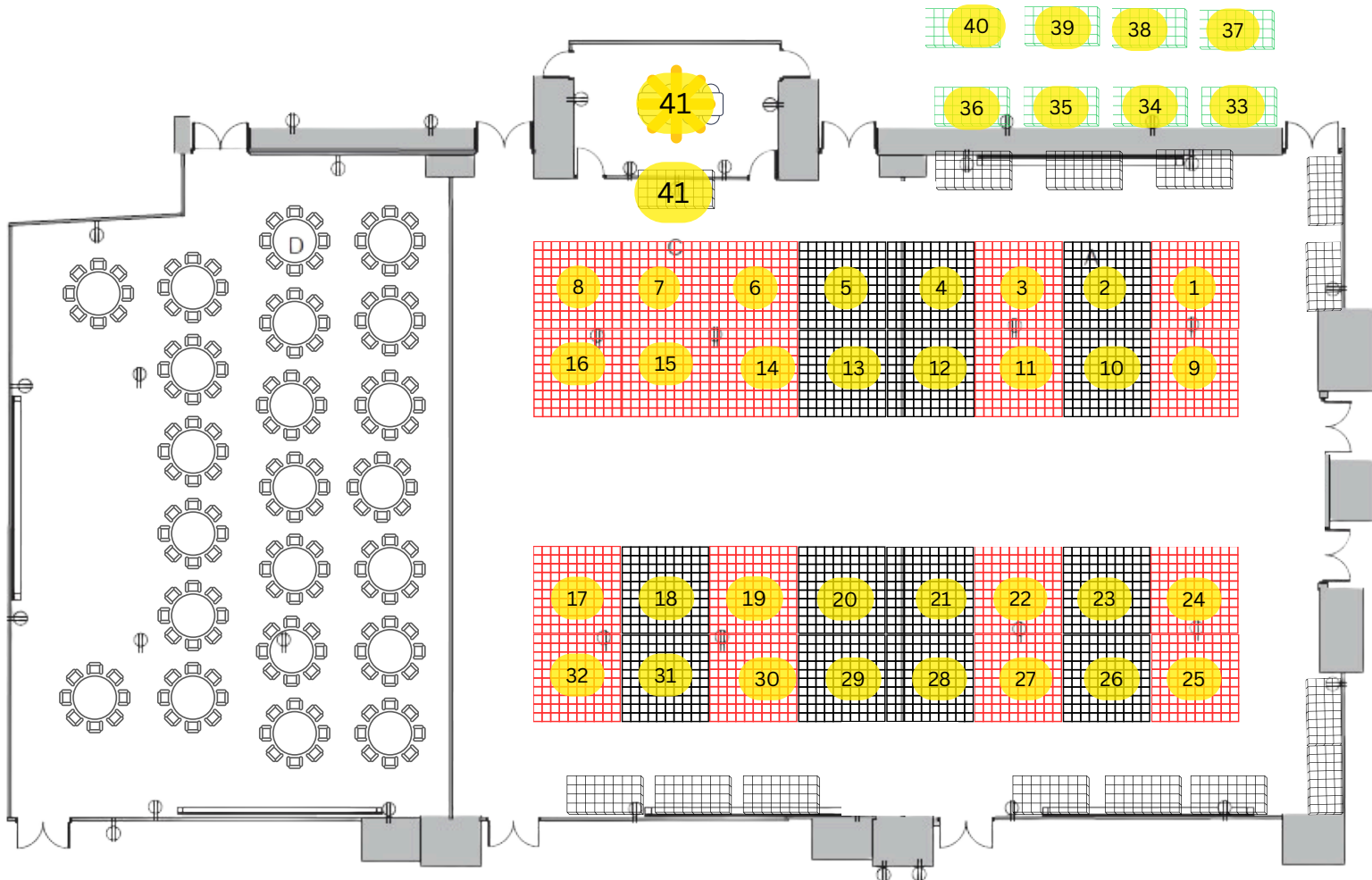

To Reserve Your Space - <https://form.jotform.com/SRL/EEA/2025exhibitor>

Sponsorship Package

- **Conference Platinum Sponsor: \$ 14,950**

- Includes first choice of any 2 booth spaces or the Discovery Room Super Booth (41)
- 3 minute speaking engagement on stage during opening session.
- 45 minute presentation on seminar schedule (Must be informative about products)
- Signage as conference sponsor on all media including 4 large monitors in the exhibit hall.
- Branded video of your products showing on exhibit hall monitors through out the day
- Branded video on the SRLEEA Website starting when sponsorship is reserved until April 2026.
- 2 page advertorial in any 2025 or 2026 magazine
- 1 page company ad in any 2025 or 2026 magazine
- Logo and link on all newsletter for 2026
- Guaranteed Sponsor Renewal for 2026

- **Reception Gold Sponsor: \$ 9,950**

- Includes second choice of any 2 booth spaces or the Discovery Room Super Booth (41).
- Includes second choice of the Super Booth / Private Booth if available.
- 3 minute speaking engagement during opening vendor hall opening.
- Signage as conference sponsor on all media including 4 large monitors in the exhibit hall.
- Branded video of your products showing on exhibit hall monitors through out the day.
- 1 page company ad in any 2025 or 2026 magazine
- Guaranteed Sponsor Renewal for 2026



Conference Accommodation

This year, SRLEEA is excited to have arranged two accommodation options for attendees.

Option #1: KU Resident Hall Single Dorm Rooms

SRLEEA has secured 180 affordable private accommodations in residence hall on campus:

\$66.00/night (the first night)

\$44.00/night (each additional night)

Reserve your room directly with the University of Kansas by completing the online form: Note that your booking is an agreement between yourself and the University of Kansas. Use the link below or scan the QR code with your smart phone camera.

<https://tinyurl.com/mylodging>



JAYHAWK
HOSPITALITY
The University of Kansas



- Attendees must **sign up by June 15th** to have a private room on campus.
- Housing department will bill by July 1st. They will receive an electronic invoice from housing@ku.edu. The invoice will have the link to pay, and it must be paid with a card.
- **Attendees must pay by July 15th . If they do not pay by this date, they forfeit their spot in housing. Additionally, there are no refunds for housing after paying.**

Option #2: Local Hotels:

SRLEEA has secured special room rates at the below local hotels. Discounted rates apply until

IMPORTANT - When reserving your room at the below hotels ask for Group Rate (University of Kansas Center for Public Safety)

SRLEEA HOST HOTEL - The Oread by Hilton - 1200 Oread Avenue , Lawrence, KS, 66044
\$140.00 per night - **(785) 843-1200**

DoubleTree by Hilton Lawrence - 200 McDonald Drive, Lawrence KS 66044
\$109.00 per night - **(785)-841-7077**

SpringHill Suite - 1 RIVERFRONT PLAZA, LAWRENCE, KS 66044
\$123.00 per night - **785-841-2700**

Hampton Inn - 2300 West 6th Street, Lawrence, KS 66049
\$149 per night on July 26, 2025
\$110 per night on July 27, 28, 29 or 30th - **(785) 841-4994**

University of Kansas-Lawrence Annotated Campus Map for EER 2018



*The majority of the EER events will take place in KU's new Earth, Energy & Environment Center (EEEC) a multidisciplinary facility that includes Ritchie Hall and Slawson Hall –with bridges to Lindley Hall and Learned Hall and the new Burge Student Union.

- University Inn**
 2309 Iowa St.
 (785) 843-9100
- Hampton Inn**
 2300 W 6th St.
 (785) 841-4994
- Oread Hotel, Bar, & Restaurant**
 1200 Oread Ave
 (785) 843-1200
- Self Residence Hall**
 1620 Engel Rd.
 (785) 864-4515
- *Earth, Energy, & Environment Center (EEEC):**
 Lindley/Richie/Slawson Hall
 Crescent Rd and Naismith Dr.
- Burge Student Union**
 1565 Irving Hill Rd.
- On-campus Food Options:**
 Mrs E's, Lewis Hall | The Bus Stop, Self Hall
 B: Burge Market Place, Burge Student Union
 C: Courtside Cafe and Roasterie Coffee, De Bruce Cafe
 D: McLain's Market
 E: The Underground, Wescope Hall
 F: Impromptu Café, Roasterie, and The Market, Kansas Memorial Union
- P** Closest free lots: 110 and 72. Green lots are free in summer.

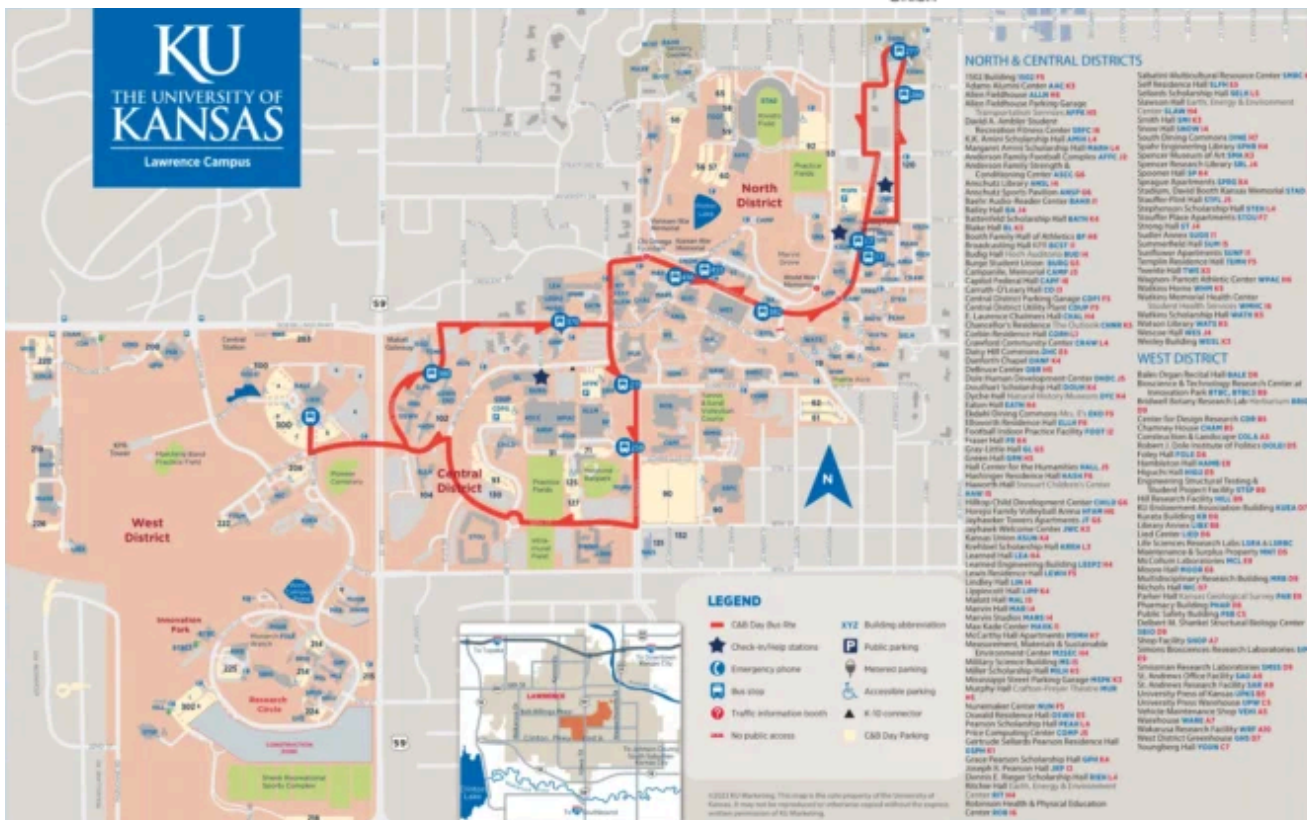

©2018 KU Lawrence. This map is the sole property of the University of Kansas. It may not be reproduced or otherwise used without the express written permission of KU Lawrence.

There are several FedEx and UPS shipping locations near the University of Kansas

FedEx Authorized Ship Center: Located at 725 N 2nd St Ste Q, Lawrence, KS 66044

FedEx at Walgreens: Located at 400 W 23rd St, Lawrence, KS 66046 and 3421 W 6th St, Lawrence, KS 66049

FedEx at Office Depot: Located at 2525 Iowa St, Lawrence, KS 66046

The UPS Store: Located at 2040 W 31st St, Ste G, Lawrence, KS 66046

UPS locations also include Access Points inside CVS, Michaels, and Sound Innovations.

UPS offers a variety of shipping services, including packing, printing, shredding, notarizing, faxing, and mailboxes. FedEx offers expedited and standard parcel services, including international shipping.

On-site shipping coming soon!

[Secure Your Space Today >](https://form.jotform.com/SRLEEA/2025exhibitor)



<https://form.jotform.com/SRLEEA/2025exhibitor>

Email - conference@smallrural.org

**Small & Rural Law Enforcement
Executives Association**

**Address: 1520 Belle View Blvd,
Suite 5100, Alexandria, VA 22307**

Phone: (571) 758-4170